



## SRX-T615

### Super-high Picture Quality 4K Digital Projector

#### FEATURES

##### High Picture Quality

The SRX-T615 features a high-contrast image of 12,000:1, high brightness of 18,000 lm, and brightness uniformity with the new 4K optical engine.

##### Low Running Costs

Using multiple HPM lamps in individual cartridges means that lamp replacement is easier and safer, and provides a longer lamp-exchange cycle. Lamp costs for the SRX-T615 are much lower than with Xenon lamps. Also, durable parts incur fewer maintenance cycles which further reduces running costs.

##### Application Versatility

The SRX-T615 offers the flexibility of tilted installation, distortion correction for 4K3D, and edge blending for multi projection. It also provides a variety of lamp operations for precise luminance control, such as a selectable number of lighting lamps and interleaved lamp control.

# SPECIFICATIONS

		SRX-T615
Display System	4K SXRD panel, projection system	
Display elements	Effective display size	1.48" x 3
	Number of pixels	26,542,080 (4096 x 2160 x 3) pixels
Light source	High-pressure mercury lamp, 6 x 450 W or 6 x 330 W type	
Recommended lamp replacement time*1	2000 H (450 W) / 3000 H (330 W)	
Light output	18,000 Center lumens / 17,000 lumens*3	
	(6 x 450 W lamp)	
	13,500 Center lumens / 12,500 lumens*3	
		(6 x 330 W lamp)
Contrast ratio	12,000:1	
INPUT / OUTPUT	HDMI (2 inputs)	Digital RGB/Y Pb/Cb Pr/Cr
	DisplayPort (4 inputs)*2	Digital RGB/Y Pb/Cb Pr/Cr
Video / Control	REMOTE	RS-232C, D-sub 9-pin (female)
	LAN	10BASE-T / 100BASE-T
Operating temperature / Operating humidity		
5°C to 35°C (41°F to 95°F) / 35% to 85% (no condensation)		
Storage temperature / Storage humidity		
-20°C to +60°C (-4°F to +140°F) / 10% to 90% (no condensation)		
Power requirements		
AC 200 V to 240 V, 21.5 A to 18 A, 50/60 Hz, Single Phase		
Dimensions (W x H x D)		
548 x 634 x 1119 mm		
21 5/8 x 25 x 44 1/8 inches		
Mass	Approx. 143 kg / 315.3 lb	

\*1 The figures are expected maintenance time and not guaranteed. They will depend on the environment or how the projector is used.  
 \*2 Available in 2013 with optional board manufactured by 3rd party.  
 \*3 Those brightness are measured in accordance with ISO 21118. It is usually called "ANSI lumen".

# OPTIONAL ACCESSORIES

## 2D Lens

	LKRL-Z511	LKRL-Z514	LKRL-Z519
Throw ratio*	1.05 – 1.75	1.35 – 2.34	1.80 – 4.00
V shift	+/- 35%	+/- 35%	+/- 35%
H shift	+/- 7%	+/- 7%	+/- 7%
Dimensions	W 256 x H 315 x D 429 mm	W 256 x H 315 x D 454 mm	W 256 x H 315 x D 413 mm
Mass	14.5 kg	14.0 kg	13.0 kg

## 3D Lens

	LKRL-A502	LKRL-A503
Throw ratio*	1.03 – 1.85	1.70 – 3.76
V shift	- 50%	- 50%
H shift	+/- 7%	+/- 7%
Attached 3D filter	LKRA-005	LKRA-005
Dimensions	W 256 x H 340 x D 559 mm	W 256 x H 340 x D 562 mm
Mass	12.0 kg	12.0 kg

\* Throw distance definition needs not only lens throw ratio but also projection screen aspect.

## Lamp

	LKRM-U450	LKRM-U330
Recommended replacement time	2,000 hours*	3,000 hours*
Dimensions	W 89 x H 122 x D 148 mm	W 89 x H 122 x D 148 mm
Mass	510 g	510 g

\* Recommended replacement time are different for their usage environment.

# CONNECTOR PANEL

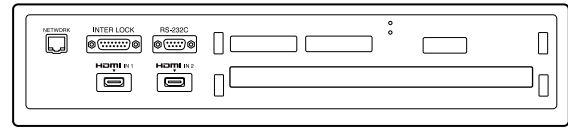

# DIMENSIONS

Unit: mm (inches)

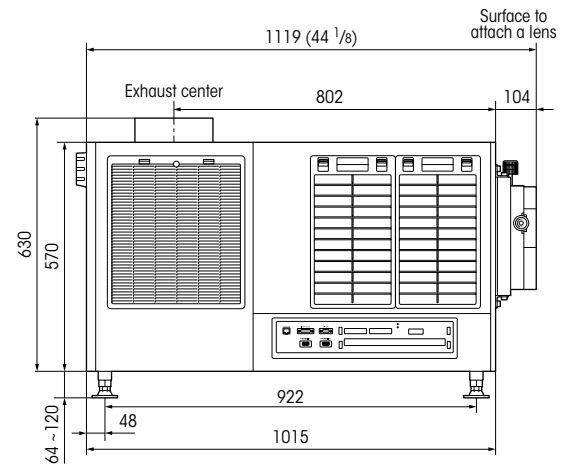
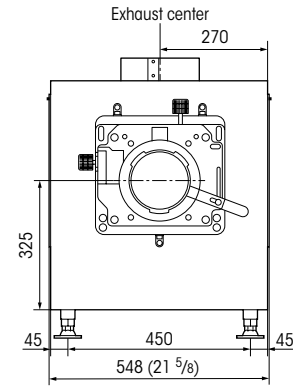

# APPLICATIONS

## Entertainment

- Amusement parks
- Planetariums
- Museums

## Visual simulation

- Simulators
- Scientific visualization
- Oil and Gas

## Industrial design

- Digital mock-ups
- Automotive design

## Other

- Command and Control
- 3D applications
- 4K content viewing

Distributed by

©2013 Sony Corporation. All rights reserved. Reproduction in whole or in part without written permission is prohibited. Features and specifications are subject to change without notice.

The values for mass and dimension are approximate. "SONY", "make.believe", and "SXRD" are trademarks of Sony Corporation. The terms HDMI and HDMI High-Definition Multimedia Interface, and the HDMI Logo are trademarks or registered trademarks of HDMI Licensing LLC in the United States and other countries. All other trademarks are the property of their respective owners.